

spatialCONFLATOR

Improve the Accuracy of Network Assets With spatialCONFLATOR

A scalable data conflation engine that improves the positional accuracy of communications network assets as new information becomes available

Communications network asset data often evolves from a wide variety of sources and accuracies including other GIS systems, CAD drawings, and even heads up digitizing from paper maps. These data may have been registered on old landbase information which results in relative and absolute inaccuracies. As a result, network asset databases often show data in an incorrect position relative to the real world when compared with a modern, high accuracy landbase or imagery dataset. Enterprise users of these databases may make incorrect decisions based on assets displayed on the wrong side of the road, and field workers may lose efficiency by having to constantly revisit and update information when they discover inaccuracies.

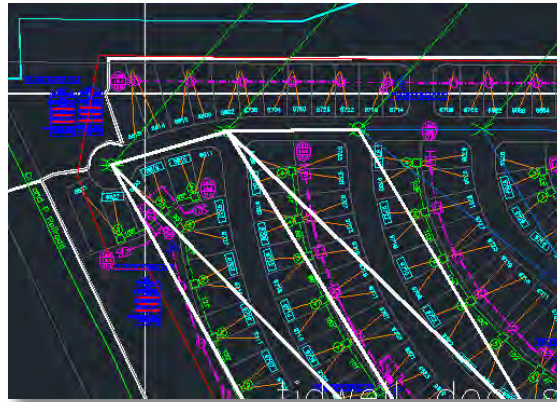

Designed for GIS technicians, engineers, mappers, and engineering contractors who are responsible for maintaining network asset data, spatialCONFLATOR is a powerful new offering from Synchronoss that delivers a sustainable methodology for improving the accuracy of network asset databases.

spatialCONFLATOR is an interactive tool that “conflates” spatial data in a spatialSUITE database by using control points to adjust a set of source data with landbase or other control data in such a way that positional accuracy of the source data aligns with the control data. A spatialCONFLATOR user creates a grid of “control points” that designate matching locations in each dataset, such as street intersections, and the system uses those points to incrementally adjust the source data according to the calculated difference from the corresponding control data at every point.

Create Control Points

spatialCONFLATOR provides a flexible interface for developing control point files of any complexity, with tools to identify areas with large errors, preview the impact of the control points, and rapidly extend the control point network. Users can save control point files for use with other datasets and even other systems. A robust control point file is the most important input to the conflation process, and generally one of the most complicated to achieve. spatialCONFLATOR has the user-oriented tools to make this task easy to complete with visual feedback at every step.

KEY BENEFITS

Significantly reduces the manual labor associated with traditional rubber sheeting approaches

Seamless, in-situ conflation that does not require import/export routines on the database

Automatic preservation and adjustment of symbols and annotation within the source data

Flexibility to adjust portions of the database by area and feature type

Database management with Synchronoss’ Job Management System (JMS) to allow conflation results to be rolled back

Preview Conflation Results

At any time in the control point creation process, conflation results can be previewed to assess accuracy. Being able to preview the conflation saves time from having to perform the conflation then roll back the results if they are not what was expected. The preview capability helps control point files be developed quickly and accurately.

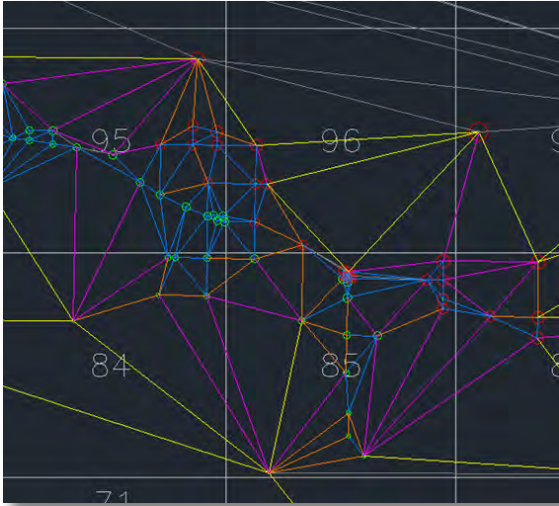

Conflate All Or Part of A spatialSUITE Database

spatialCONFLATOR provides control over what areas of the database are conflated by defining a control point boundary that can lie within the control point triangulation network, at the edge, or beyond the current control point network. This control provides an ongoing mechanism to adjust new data in the system without impacting data that was previously adjusted.

Conflate Standalone CAD Files

spatialCONFLATOR can now conflate CAD drawings in a standalone environment with any database connection. Users can select multiple files to conflate in a single operation based on a set of control points. spatialCONFLATOR will open each CAD drawing, conflate if necessary, then save the drawing in a new folder.

Conflate Data Safely In A JMS Environment

spatialCONFLATOR works within a long transaction Job Management Systems (JMS) environment, allowing the results of a conflation run to be reviewed and approved before posting the changes to the database. Working within a JMS job preserves data integrity by preventing conflation work from impacting other users, and allows the conflation results to be rolled back if necessary.

Experience the Benefits of spatialCONFLATOR

spatialCONFLATOR is a key component of an efficient and productive network asset management system. The solution significantly reduces the manual labor associated with traditional rubber sheeting approaches and effectively manages data accuracy as well as the ongoing evolution of network asset and landbase data. As a result, spatialCONFLATOR reduces errors and rework, lowers turnaround time, and increases efficiency and decision making.



Synchronoss Technologies
200 Crossing Blvd.
Bridgewater, NJ 08807

Please call us at **1-866-620-3940**

Web: www.synchronoss.com

Blog: <http://blog.synchronoss.com>

Twitter: <http://twitter.com/synchronoss>

About Synchronoss Technologies, Inc.

Synchronoss Technologies (NASDAQ: SNCR) is the mobile innovation company that provides software-based activation and mobile content management solutions for connected devices across the globe. The company's proven and scalable technology solutions allow customers to connect, synchronize and activate connected devices and services that empower enterprises and consumers to live in a connected world.